

| REV | EC# or BY | DESCRIPTION | DATE |
|-----|-----------|------------------------|---------|
| A | DPP | DELETED THE SET COLLAR | 9/25/01 |

AUGER INSTALLATION TOOL SET-UP DIRECTIONS

1. Rotate the augershaft manually until one of the keyways is located at the top of the augershaft.
2. Install the Extension Support (Item #3) onto the left handed stud at the front of the augershaft. TIGHTEN SECURELY! Note: The LH stud needs to be in good condition for the tool to be anchored properly. If in doubt replace the LH stud at this time.
3. Install the Back-up Spiral Support (Item #2) onto the Extension Support (Item #3). Rotate the Back-up Spiral Support so the two holes in the side are located at the top.
4. Lay the Fast Feed Spiral Slide (Item #1) onto the Back-up Spiral Support (Item #2) so the Slide lays in the keyway and butts against the driving face of the augershaft.
5. Tighten the set screws on the Back-up Spiral Support (Item #2) to prevent the Fast Feed Spiral Slide (Item #1) from rotating out of position. You are now ready to install the augers.

Install the fast feed spirals, then remove the Fast Feed Spiral Slide (Item #1).
 Install the back-up spirals, then remove the Back-up Spiral Support (Item #2).
 Install the point auger, then remove the Extension Support (Item #3).
 Secure the point auger with the cup washer and nut.

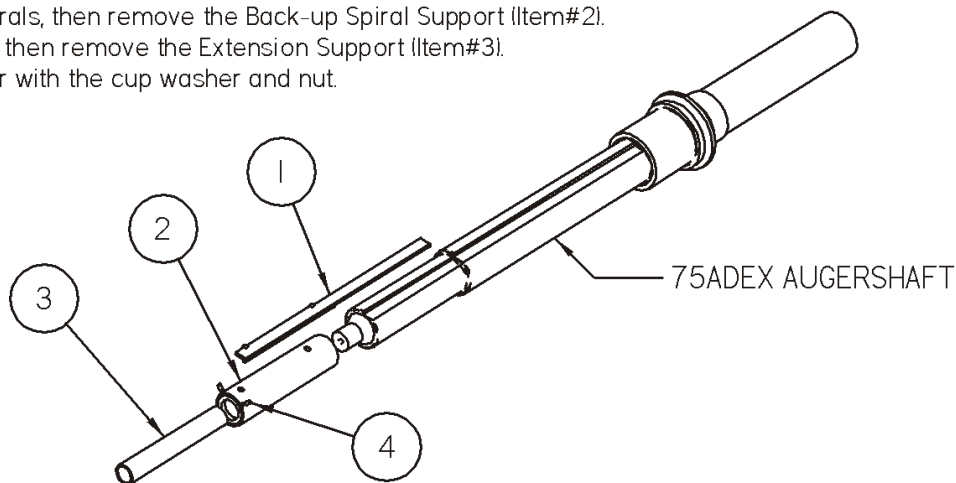

| Item No. | Document No. | Title | Qty |
|----------|---------------|--|-----|
| 1 | DRD-S-1604-SR | FAST-FEED SPIRAL SLIDE | 1 |
| 2 | DRD-S-1603-SR | BACK-UP SPIRAL SUPPORT | 1 |
| 3 | DSD-S-1602-SR | EXTENSION SUPPORT | 1 |
| 4 | PSB-S-2122-SP | 1/2" x 1" SOC HD SET SCREW (DOG POINT) | 2 |

THIS DRAWING AND THE INFORMATION HEREIN ARE THE SOLE PROPERTY OF
 AND SUBJECT TO RECALL BY J.C.S. & S. IT MAY NOT BE USED OR
 REPRODUCED WITHOUT THE WRITTEN CONSENT OF J.C.S. & S.

MACHINE: 75ADEX

ASSY. DWG:

MATERIAL:

TREATMENT:

DRAWN BY: DPP

DATE: 6/27/01

CHECKED BY:

DATE:

PATTERN NO:

PART NO:

PART CODE:



J.C. STEELE & SONS

710 SOUTH MULBERRY STREET
 STATESVILLE, N.C. 28677 U.S.A.

(704) 872-3681 - FAX (704) 878-0789 - <http://www.jcsteele.com>

75ADEX AUGER INSTALLATION TOOL

CUSTOMER

SIZE

SCALE

NTS

RELEASED

SHEET

OF

1

REV.

A

DRAWING
NUMBER:

DRD-D-1600-CB